

greenworks

2937207AU

P0803562-00 Rev B

EN

EDGER HEAD

OPERATOR MANUAL



E8038

PAC458

Greenworks Australia
A Division Jak Max P/L
380 Foley's Road Derrimut
Victoria, Australia 3026

www.greenworksaustralia.com

1	Description.....	2	7.1	Unpack the machine.....	6
1.1	Introduction.....	2	7.2	Assemble the shaft.....	6
1.2	Purpose.....	2	8	Operation.....	7
1.3	Overview.....	2	8.1	Adjust the depth of cut.....	7
2	General power tool safety		8.2	Replace the blade.....	7
	warnings.....	2	8.3	Operation tips.....	7
2.1	Training.....	2	9	Maintenance.....	8
2.2	Preparation.....	2	9.1	General information.....	8
2.3	Operation.....	3	9.2	Clean the machine.....	8
2.4	Maintenance.....	3	9.3	Replace the skid plate.....	8
2.5	Service.....	4	9.4	Replace the wheel.....	8
3	String trimmer and brush cutter		10	Transportation and storage.....	9
	safety warnings.....	4	10.1	Move the machine.....	9
4	Symbols on the product.....	5	10.2	Store the machine.....	9
5	Risk levels.....	6	11	Troubleshooting.....	9
6	Recycle.....	6	12	Technical data.....	9
7	Installation.....	6	13	Warranty.....	9

1 DESCRIPTION

1.1 INTRODUCTION

Your product has been engineered and manufactured to high standards for dependability, ease of operation, and operator safety. When properly cared for, it will give you years of rugged, trouble-free performance.

1.2 PURPOSE

This edger is used to trim and cut around the edge of driveways, side walks and more. The edger is not meant to be used to cut hedges, shrubs, bushes, or flowers.

1.3 OVERVIEW

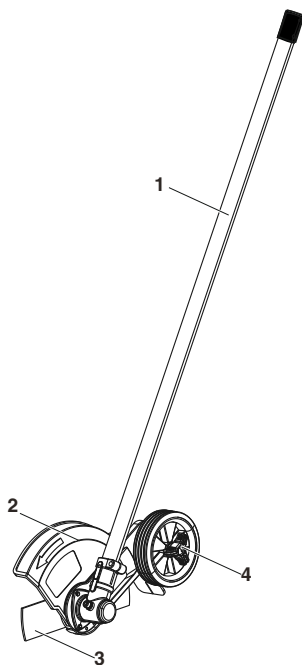

- 1 Edger attachment
- 2 Guard
- 3 Blade
- 4 Depth adjustment knob

2 GENERAL POWER TOOL SAFETY WARNINGS

▲ WARNING

Read all safety warnings and all instructions. Failure to follow the warnings and instructions may result in electric shock, fire and/or serious injury.

Save all warnings and instructions for future reference.

The term "power tool" in the warnings refers to your battery-operated (cordless) power tool.

2.1 TRAINING

- Read the instructions carefully. Be familiar with the controls and the correct use of the machine.
- Never allow children, persons with reduced physical, sensory or mental capabilities or lack of experience and knowledge or people unfamiliar with these instructions to use the machine. Local regulations can restrict the age of the operator.
- Keep in mind that the operator or user is responsible for accidents or hazards occurring to other people or their property.

2.2 PREPARATION

- Before use, check the battery pack for signs of damage or aging. If the battery becomes damaged during use, switch

off the power tool and remove the battery immediately. Do not use the power tool if the battery is damaged or worn.

- Before use, always visually inspect the power tool for damaged, missing or misplaced guards or shields.

2.3 OPERATION

- Keep power cords away from cutting means.
- Wear eye protection and stout shoes at all times while operating the power tool.
- Avoid using the power tool in bad weather conditions especially when there is a risk of lightning.
- Use the power tool only in daylight or good artificial light.
- Never operate the power tool with damaged guards or shields or without guards or shields in place.
- Switch on the motor only when the hands and feet are away from the cutting means.
- Always disconnect the power tool from the power supply (i.e. remove the plug from the

mains, remove the disabling device or removable battery)

- whenever the power tool is left unattended;
- before clearing a blockage;
- before checking, cleaning or working on the power tool;
- after striking a foreign object;
- whenever the power tool starts vibrating abnormally.
- Take care against injury to feet and hands from the cutting means.
- Always ensure that the ventilation openings are kept clear of debris.

2.4 MAINTENANCE

- Disconnect the power tool from the power supply (i.e. remove the plug from the mains, remove the disabling device or removable battery) before carrying out maintenance or cleaning work.
- Use only the manufacturer's recommended replacement parts and accessories.
- Inspect and maintain the power tool regularly. Have the

power tool repaired only by an authorized repairer.

- When not in use, store the power tool out of the reach of children.

2.5 SERVICE

- **Have your power tool serviced by a qualified repair person using only identical replacement parts.** This will ensure that the safety of the power tool is maintained.

3 STRING TRIMMER AND BRUSH CUTTER SAFETY WARNINGS

- Children shall not play with the power tool.
- Cleaning and user maintenance shall not be made by children without supervision.
- The battery must be removed from the power tool before it is scrapped.
- The power tool must be disconnected from the supply mains when removing the battery.
- The battery is to be disposed of safely.

- Do not overreach. Keep proper footing and balance at all times. This enables better control of the power tool in unexpected situations.
- Dress properly. Do not wear loose clothing or jewellery. Keep your hair, clothing and gloves away from moving parts. Loose clothes, jewellery or long hair can be caught in moving parts. While operating the machine always wear substantial footwear and long trousers.
- This power tool is not intended for use by persons (including children) with reduced physical, sensory or mental capabilities, or lack of experience and knowledge, unless they have been given supervision or instruction concerning use of the power tool by a person responsible for their safety.
- Children should be supervised to ensure that they do not play with the power tool.
- Do not touch moving hazardous parts before the machine is disconnected from





the mains and the moving hazardous parts have come to a complete stop. Never to replace the non-metallic cutting means with metallic cutting means.

- Never operate the machine while people, especially children, or pets are nearby.
- Always be sure of your footing on slopes.
- Walk, never run.
- Never use the machine when the operator is tired, ill or under the influence of alcohol or other drugs.
- Use a transport cover for metal blades during transport and storage.
- Regular maintenance tasks, pre-operational measures and daily maintenance techniques, including checking for loose fasteners and damaged parts, such as cracks in the cutting attachment.
- Cleaning and maintenance before storage, including the use of guards on cutting attachments with metal blades.

- Need for daily inspection before use and after dropping or other impacts to identify any significant defects.

4 SYMBOLS ON THE PRODUCT

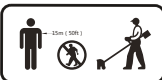

Some of the following symbols may be used on this tool. Please study them and learn their meaning. Proper interpretation of these symbols will allow you to operate the tool better and safer.

Symbol	Explanation
	Read and understand all instructions before operating the product, follow all warnings and safety instructions.
	Wear head protection.
	Wear eye and ear protection.
	Wear safety footwear.
	Wear protective gloves.
	Do not expose the product to rain or moist conditions.
	Be aware of blade thrust. Take care against injury to feet and hands from the cutting means.
	Thrown objects can ricochet and result in personal injury or property damage. Wear protective clothing and boots.
	Do not use saw blades.
	Beware of thrown or flying objects. Keep all bystanders, especially children and pets, at a safe distance at least 15 m away from the operating area.



Symbol	Explanation
	Direction of rotation.

5 RISK LEVELS

The following signal words and meanings are intended to explain the levels of risk associated with this product.

SYM-BOL	SIGNAL	MEANING
	DANGER	Indicates an imminently hazardous situation, which, if not avoided, will result in death or serious injury.
	WARNING	Indicates a potentially hazardous situation, which, if not avoided, could result in death or serious injury.
	CAUTION	Indicates a potentially hazardous situation, which, if not avoided, may result in minor or moderate injury.
	CAUTION	(Without Safety Alert Symbol) Indicates a situation that may result in property damage.

6 RECYCLE

	Separate collection. You must not discard with usual household waste. If it is necessary to replace the machine, or if it is no more use to you, do not discard it with household waste.
	Separate collection of used machine and packaging let you recycle materials and use them again. Use of the recycled materials helps prevent environmental pollution and decreases the requirements for raw materials.
	At the end of their useful life, discard batteries with a precaution for our environment. The battery contains material that is dangerous to you and the environment. You must remove and discard these materials separately at a location that accepts lithium-ion batteries.

7 INSTALLATION

7.1 UNPACK THE MACHINE

▲ WARNING

Make sure that you correctly assemble the machine before use.

▲ WARNING

- If parts of the machine are damaged, do not use the machine.
- If you do not have all the parts, do not operate the machine.
- If parts are damaged or missing, contact the service center.

1. Open the package.
2. Read the documentation provided in the box.
3. Remove all the unassembled parts from the box.
4. Remove the machine from the box.
5. Discard the box and packing material in compliance with local regulations.

7.2 ASSEMBLE THE SHAFT

1. Loosen the knob (1) on the coupler.
2. Push in the release button (2) on the lower shaft (3).
3. Align the release button (2) with the positioning hole (4) and slide the two shafts.

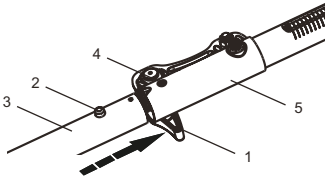

4. Turn the lower shaft until the button locks into the positioning hole.

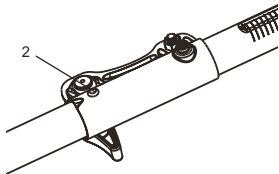

5. Tighten the knob.

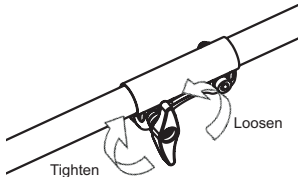

8 OPERATION

i IMPORTANT

Before you operate the machine, read and understand the safety regulations and the operation instructions.

▲ WARNING

Be careful when you operate the machine.

8.1 ADJUST THE DEPTH OF CUT

1. Remove the battery pack.
2. Loosen the depth adjustment knob to increase or decrease the depth.

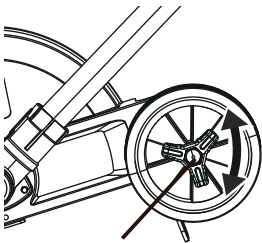

Depth Adjustment Knob

3. Adjust the depth so that the blade barely touches the ground when the machine is held in a normal operating posture.
4. Tighten the depth adjustment knob.
5. Standing in a normal working position, check the depth of cut again and correct if necessary.
6. Replace the battery pack once all adjustments are complete.

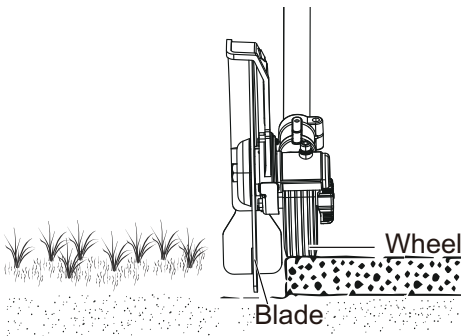

8.2 REPLACE THE BLADE

i NOTE

If the blade worn out, replace it with a new one (not provided).

1. Use a metal rod (4) to fix the blade.
2. Remove the nut (1) by turning it clockwise with the wrench (5) (not included).
3. Remove the outer cup (2) and the plate (3).

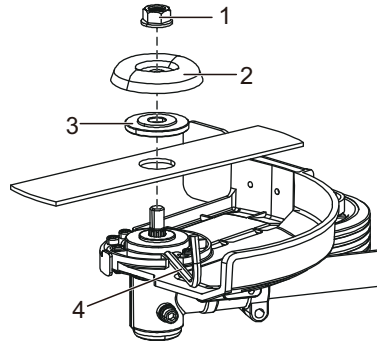

4. Remove the old blade and replace it with a new one.
5. Place the plate and outer cup on the blade.
6. Place the nut on the washer and tighten it counterclockwise with the wrench provided.

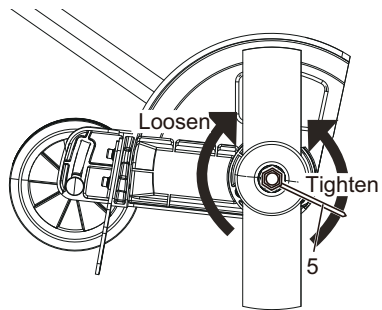

8.3 OPERATION TIPS

▲ WARNING

Always hold the edger away from the body keeping clearance between your body and the edger. Any contact with the edger cutting head while operating can result in serious personal injury.

- Hold the edger with your right hand on the rear handle and your left hand on the front handle.
- Keep a firm grip with both hands while in operation.

- Edger should be held at a comfortable position with the rear handle about hip height.
- The edger will edge along sidewalks, driveways, flower beds, curbs, and similar areas.
- Cut at a steady pace. If the blade begins to bog down, you are edging too fast; slow your pace. Do not force the blade into ground.
- Light contact of the blade against the sidewalk edge, curb, etc., is acceptable and will not damage the edger.
- Best appearance is obtained when grass is dry. Avoid edging in wet soil or wet grass areas or the blade guard might clog and result in an uneven edge. If the blade guard becomes clogged, stop the edger, remove the battery, and remove debris from the blade guard.



9 MAINTENANCE

i IMPORTANT

Read and understand the safety regulations and the maintenance instructions before you clean, repair or do the maintenance work on the machine.

i IMPORTANT

Make sure that all nuts, bolts and screws are tight. Examine regularly that you install the handles tightly.

i IMPORTANT

Use only the replacement parts and accessories of the initial manufacturer.

9.1 GENERAL INFORMATION

i IMPORTANT

Only your dealer or approved service center can do the maintenance that is not given in this manual.

Before the maintenance operations:

- Stop the machine.
- Remove the battery pack.
- Cool the motor.
- Store the machine in cool and dry place.
- Use correct clothing, protective gloves and safety glasses.

9.2 CLEAN THE MACHINE

- Clean the machine after use with a moist cloth dipped in neutral detergent.
- Do not use aggressive detergents or solvents to clean the plastic parts or handles.
- Keep the trimmer head free of grass, leaves, or excessive grease.
- Keep the air vents clean and free of debris to avoid overheating and damage to the motor or the battery.
- Do not spray water onto the motor and electrical components.

9.3 REPLACE THE SKID PLATE

1. Remove the screws with a Phillips Head screwdriver (not included).
2. Replace with the new skid plate (1).
3. Tighten the screws.

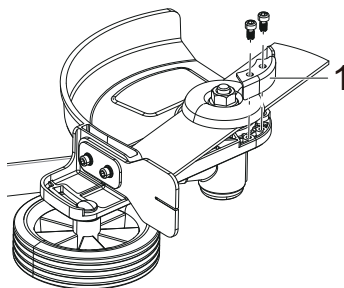

9.4 REPLACE THE WHEEL

1. Remove the battery.
2. Remove the knob (1), washer (2), wheel (3), axle sleeve (4), washer (2) and wheel axle (5) orderly from the wheel assembly.

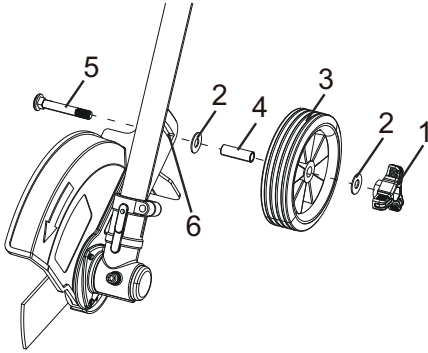

3. Replace with the new wheel.
4. Insert the wheel axle (5) through the slot (6) downward, then put the washer (2), axle sleeve (4), wheel (3), washer (2) and knob (1) orderly through the wheel axle.
5. Tighten the knob (1).

10 TRANSPORTATION AND STORAGE

▲ WARNING

Remove the battery pack from the machine before transportation and storage.

10.1 MOVE THE MACHINE

When you move the machine, you must:

- Stop the machine.
- Remove the battery pack.

10.2 STORE THE MACHINE

- Remove the battery pack from the machine.
- Make sure that children cannot come near the machine.
- Keep the machine away from corrosive agents such as garden chemicals and de-icing salts.
- Secure the machine during transportation to prevent damage or injury. Clean and examine the machine for any damage.

11 TROUBLESHOOTING

Problem	Possible Cause	Solution
The machine does not start when you push the trigger.	No electrical contact between the machine and the battery pack.	1. Remove battery pack. 2. Check contact and install the battery pack again.
	The battery pack is depleted.	Charge the battery pack.
	The lock-out button and trigger are not pushed at the same time.	1. Pull the lock-out button and hold it. 2. Pull the trigger to start the machine.
Edger stops during use.	Depth is set too low.	Adjust the depth as shown in the instruction manual.
	Walking too fast.	Do not force the edger through the grass.

12 TECHNICAL DATA

Cutting head	Blade
Blade length	225mm
Weight	1.9 kg

13 WARRANTY

(The full warranty terms and conditions can be found on Greenworks website www.greenworksaustralia.com)

The Greenworks warranty is 4 years on the product, and 2 years on batteries and chargers (consumer/private usage) from the date of purchase. This warranty covers manufacturing faults. A faulty product under warranty might be either repaired or replaced. A unit that has been misused or used in other ways then described in the owner's manual might be rejected for warranty. Normal wear, and wear parts are not considered as warranty. The original manufacturer warranty is not affected by any additional warranty offered by a dealer or retailer.

A faulty product must be returned to the point of purchase in order to claim for warranty, together with the proof of purchase (receipt).