

# greenworks<sup>®</sup>

## COMMERCIAL

82PC12  
2009307AU

EN

POWER CUTTER

OPERATOR MANUAL

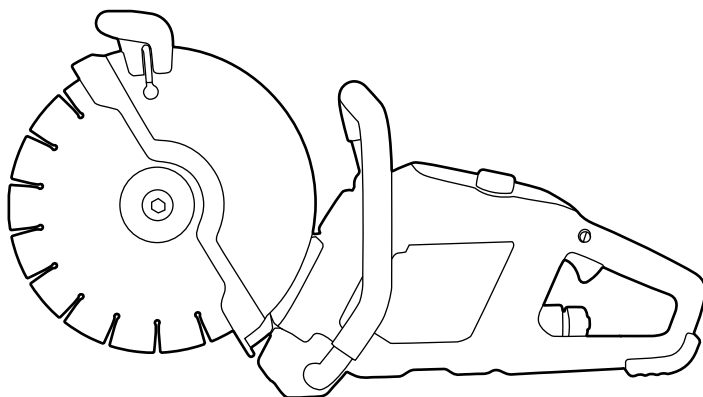

**E8038**

**PCB401**

Greenworks Australia  
A Division Jak Max P/L  
380 Foley's Road Derrimut  
Victoria, Australia 3026

[www.greenworksaustralia.com](http://www.greenworksaustralia.com)

<b>1</b>	<b>Description.....</b>	<b>2</b>	<b>10</b>	<b>Installation.....</b>	<b>6</b>
1.1	Purpose.....	2	10.1	Unpack the machine.....	7
1.2	Overview.....	2	10.2	Install the wheel.....	7
<b>2</b>	<b>General power tool safety</b>		10.3	Adjust the angle of guard.....	7
	<b>warnings.....</b>	<b>2</b>	10.4	Install the battery pack.....	8
2.1	Work area safety.....	2	10.5	Remove the battery pack.....	8
2.2	Electrical safety.....	2	<b>11</b>	<b>Operation.....</b>	<b>8</b>
2.3	Personal safety.....	3	11.1	Specific safety warnings.....	8
2.4	Power tool use and care.....	3	11.2	Hold the machine.....	8
2.5	Battery tool use and care.....	3	11.3	Start the machine.....	9
2.6	Service.....	4	11.4	Stop the machine.....	9
<b>3</b>	<b>Cut-off machine safety</b>		11.5	LED light.....	9
	<b>warnings.....</b>	<b>4</b>	11.6	Function of control panel.....	9
<b>4</b>	<b>Kickback and related</b>		11.7	Connect the water supply.....	9
	<b>warnings.....</b>	<b>4</b>	<b>12</b>	<b>Maintenance.....</b>	<b>9</b>
<b>5</b>	<b>Symbols on the product.....</b>	<b>5</b>	12.1	Replace the wheel.....	10
<b>6</b>	<b>Risk levels.....</b>	<b>6</b>	12.2	Clean the machine.....	10
<b>7</b>	<b>Environmentally safe battery</b>		<b>13</b>	<b>Transportation and storage.....</b>	<b>10</b>
	<b>disposal.....</b>	<b>6</b>	<b>14</b>	<b>Troubleshooting.....</b>	<b>11</b>
<b>8</b>	<b>Proposition 65.....</b>	<b>6</b>	<b>15</b>	<b>Technical data.....</b>	<b>12</b>
<b>9</b>	<b>Save these instructions.....</b>	<b>6</b>	<b>16</b>	<b>Limited warranty.....</b>	<b>12</b>

## 1 DESCRIPTION

### 1.1 PURPOSE

This product is used for cutting concrete and metal. It is not designed for cutting wood.

This appliance is not intended for use by persons with reduced understanding, or lack of experience and knowledge, unless they have been given supervision or instruction concerning use of the appliance by a person responsible for their safety.

Never allow children to operate this product.

Never allow adults to operate this equipment without proper instruction.

### 1.2 OVERVIEW

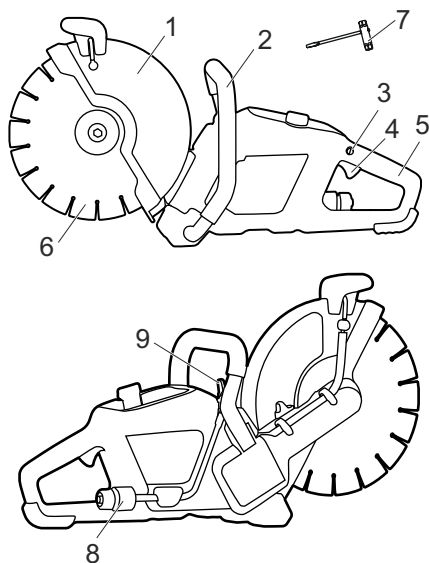

- |                                   |                         |
|-----------------------------------|-------------------------|
| 1 Guard                           | 6 Diamond cut-off wheel |
| 2 Front handle / Auxiliary handle | 7 Wrench                |
| 3 Lock-out button                 | 8 Coupling              |
| 4 Trigger                         | 9 Water adjuster        |
| 5 Rear handle / Main handle       |                         |

## 2 GENERAL POWER TOOL SAFETY WARNINGS

### ▲ WARNING

**Read all safety warnings, instructions, illustrations and specifications provided with this power tool. Failure to follow the warnings and instructions may result in electric shock, fire and/or serious injury.**

**Save all warnings and instructions for future reference.**

*The term "power tool" in the warnings refers to your mains-operated (corded) power tool or battery-operated (cordless) power tool.*

### 2.1 WORK AREA SAFETY

- **Keep work area clean and well lit. Cluttered or dark areas invite accidents.**
- **Do not operate power tools in explosive atmospheres, such as in the presence of flammable liquids, gases or dust. Power tools create sparks which may ignite the dust or fumes.**
- **Keep children and bystanders away while operating a power tool. Distractions can cause you to lose control.**

### 2.2 ELECTRICAL SAFETY

- **Power tool plugs must match the outlet. Never modify the plug in any way. Do not use any adapter plugs with earthed (grounded) power tools. Unmodified plugs and matching outlets will reduce risk of electric shock.**
- **Avoid body contact with earthed or grounded surfaces, such as pipes, radiators, ranges and refrigerators. There is an increased risk of electric shock if your body is earthed or grounded.**
- **Do not expose power tools to rain or wet conditions. Water entering a power tool will increase the risk of electric shock.**
- **Do not abuse the cord. Never use the cord for carrying, pulling or unplugging the power tool. Keep cord away from heat, oil, sharp edges or moving parts. Damaged or entangled cords increase the risk of electric shock.**
- **When operating a power tool outdoors, use an extension cord suitable for outdoor use. Use of a cord suitable for outdoor use reduces the risk of electric shock.**
- **If operating a power tool in a damp location is unavoidable, use a ground fault circuit interrupter (GFCI) protected supply. Use of an GFCI reduces the risk of electric shock.**

## 2.3 PERSONAL SAFETY

- **Stay alert, watch what you are doing and use common sense when operating a power tool.** Do not use a power tool while you are tired or under the influence of drugs, alcohol or medication. A moment of inattention while operating power tools may result in serious personal injury.
- **Use personal protective equipment. Always wear eye protection.** Protective equipment such as a dust mask, non-skid safety shoes, hard hat or hearing protection used for appropriate conditions will reduce personal injuries.
- **Prevent unintentional starting.** Ensure the switch is in the off position before connecting to power source and/or battery pack and when picking up or carrying the tool. Carrying power tools with your finger on the switch or energizing power tools that have the switch on invites accidents.
- **Remove any adjusting key or wrench before turning the power tool on.** A wrench or a key left attached to a rotating part of the power tool may result in personal injury.
- **Do not over-reach.** Keep proper footing and balance at all times. This enables better control of the power tool in unexpected situations.
- **Dress properly.** Do not wear loose clothing or jewelry. Keep your hair, clothing and gloves away from moving parts. Loose clothes, jewelry or long hair can be caught in moving parts.
- **If devices are provided for the connection of dust extraction and collection facilities, ensure these are connected and properly used.** Use of dust collection can reduce dust related hazards.
- **Do not let familiarity gained from frequent use of tools allow you to become complacent and ignore tool safety principles.** A careless action can cause severe injury within a fraction of a second.

## 2.4 POWER TOOL USE AND CARE

- **Use only diamond cut-off wheels for your power tool.** Just because an accessory can be attached to your power tool, it does not assure safe operation.
- **Do not force the power tool.** Use the correct power tool for your application. The correct power tool will do the job better and safer at the rate for which it was designed.
- **Do not use the power tool if the switch does not turn it on and off.** Any power tool that cannot be controlled with the switch is dangerous and must be repaired.
- **Disconnect the plug from the power source and/or remove the BATTERY pack, if detachable, from the power tool before making any adjustments, changing accessories, or storing power tools.** Such preventive safety measures

*reduce the risk of starting the power tool accidentally.*

- **Store idle power tools out of the reach of children and do not allow persons unfamiliar with the power tool or these instructions to operate the power tool.** Power tools are dangerous in the hands of untrained users.
- **Maintain power tools and accessories.** Check for misalignment or binding of moving parts, breakage of parts and any other condition that may affect the power tool's operation. If damaged, have the power tool repaired before use. Many accidents are caused by poorly maintained power tools.
- **Keep cutting tools sharp and clean.** Properly maintained cutting tools with sharp cutting edges are less likely to bind and are easier to control.
- **Use the power tool, accessories and tool bits etc. in accordance with these instructions,** taking into account the working conditions and the work to be performed. Use of the power tool for operations different from those intended could result in a hazardous situation.
- **Keep handles and grasping surfaces dry, clean and free from oil and grease.** Slippery handles and grasping surfaces do not allow for safe handling and control of the tool in unexpected situations.

## 2.5 BATTERY TOOL USE AND CARE

- **Recharge only with the charger specified by the manufacturer.** A charger that is suitable for one type of battery pack may create a risk of fire when used with another battery pack.
- **Use power tools only with specifically designated battery packs.** Use of any other battery packs may create a risk of injury and fire.
- **When battery pack is not in use, keep it away from other metal objects like paper clips, coins, keys, nails, screws, or other small metal objects that can make a connection from one terminal to another.** Shorting the battery terminals together may cause burns or fire.
- **Under abusive conditions, liquid may be ejected from the battery; avoid contact.** If contact accidentally occurs, flush with water. If liquid contacts eyes, additionally seek medical help. Liquid ejected from the battery may cause irritation or burns.
- **Do not use a battery pack or tool that is damaged or modified.** Damaged or modified batteries may exhibit unpredictable behavior resulting in fire, explosion or risk of injury.
- **Do not expose a battery pack or tool to fire or excessive temperature.** Exposure to fire or temperature above 130°C (265 °F) may cause explosion.
- **Follow all charging instructions and do not charge the battery pack or tool outside the**

temperature range specified in the instructions. *Charging improperly or at temperatures outside the specified range may damage the battery and increase the risk of fire.*

## 2.6 SERVICE

- **Have your power tool serviced by a qualified repair person using only identical replacement parts.** *This will ensure that the safety of the power tool is maintained.*
- **Never service damaged battery packs.** *Service of battery packs should only be performed by the manufacturer or authorized service providers.*

## 3 CUT-OFF MACHINE SAFETY WARNINGS

- **The guard provided with the tool must be securely attached to the power tool and positioned for maximum safety, so the least amount of wheel is exposed towards the operator.** *Position yourself and bystanders away from the plane of the rotating wheel. The guard helps to protect operator from broken wheel fragments and accidental contact with wheel.*
- **Use only bonded reinforced or diamond cut-off wheels for your power tool.** *Just because an accessory can be attached to your power tool, it does not assure safe operation. NOTE: Use the wording "bonded reinforced" or "diamond" as applicable depending on the designation of the tool.*
- **The rated speed of the accessory must be at least equal to the maximum speed marked on the power tool.** *Accessories running faster than their rated speed can break and fly apart.*
- **Wheels must be used only for recommended applications.** *For example, do not grind with the side of cut-off wheel. Abrasive cut-off wheels are intended for peripheral grinding, side forces applied to these wheels may cause them to shatter.*
- **Always use undamaged wheel flanges that are of correct diameter for your selected wheel.** *Proper wheel flanges support the wheel thus reducing the possibility of wheel breakage.*
- **Do not use worn down reinforced wheels from larger power tools.** *Wheels intended for a larger power tool are not suitable for the higher speed of a smaller tool and may burst.*
- **The outside diameter and the thickness of your accessory must be within the capacity rating of your power tool.** *Incorrectly sized accessories cannot be adequately guarded or controlled.*
- **The arbour size of wheels and flanges must properly fit the spindle of the power tool.** *Wheels and flanges with arbour holes that do not match the mounting hardware of the power tool will run out of balance, vibrate excessively and may cause loss of control.*

- **Do not use damaged wheels.** *Before each use, inspect the wheels for chips and cracks. If power tool or wheel is dropped, inspect for damage or install an undamaged wheel. After inspecting and installing the wheel, position yourself and bystanders away from the plane of the rotating wheel and run the power tool at maximum no load speed for one minute. Damaged wheels will normally break apart during this test time.*
- **Wear personal protective equipment.** *Depending on application, use face shield, safety goggles or safety glasses. As appropriate, wear dust mask, hearing protectors, gloves and shop apron capable of stopping small abrasive or workpiece fragments. The eye protection must be capable of stopping flying debris generated by various operations. The dust mask or respirator must be capable of filtering particles generated by your operation. Prolonged exposure to high intensity noise may cause hearing loss.*
- **Keep bystanders a safe distance away from work area.** *Anyone entering the work area must wear personal protective equipment. Fragments of workpiece or of a broken wheel may fly away and cause injury beyond immediate area of operation.*
- **Hold the power tool by insulated gripping surfaces only, when performing an operation where the cutting accessory may contact hidden wiring or its own cord.** *Cutting accessory contacting a "live" wire may make exposed metal parts of the power tool "live" and could give the operator an electric shock.*
- **Position the cord clear of the spinning accessory.** *If you lose control, the cord may be cut or snagged and your hand or arm may be pulled into the spinning wheel.*
- **Never lay the power tool down until the accessory has come to a complete stop.** *The spinning wheel may grab the surface and pull the power tool out of your control.*
- **Do not run the power tool while carrying it at your side.** *Accidental contact with the spinning accessory could snag your clothing, pulling the accessory into your body.*
- **Regularly clean the power tool's air vents.** *The motor's fan will draw the dust inside the housing and excessive accumulation of powdered metal may cause electrical hazards.*
- **Do not operate the power tool near flammable materials.** *Sparks could ignite these materials.*
- **Do not use accessories that require liquid coolants.** *Using water or other liquid coolants may result in electrocution or shock.*

## 4 KICKBACK AND RELATED WARNINGS

Kickback is a sudden reaction to a pinched or snagged rotating wheel. Pinching or snagging causes rapid

stalling of the rotating wheel which in turn causes the uncontrolled power tool to be forced in the direction opposite of the wheel's rotation at the point of the binding.

For example, if an abrasive wheel is snagged or pinched by the workpiece, the edge of the wheel that is entering into the pinch point can dig into the surface of the material causing the wheel to climb out or kick out. The wheel may either jump toward or away from the operator, depending on direction of the wheel's movement at the point of pinching. Abrasive wheels may also break under these conditions.

Kickback is the result of power tool misuse and/or incorrect operating procedures or conditions and can be avoided by taking proper precautions as given below.

- **Maintain a firm grip on the power tool and position your body and arm to allow you to resist kickback forces. Always use auxiliary handle, if provided, for maximum control over kickback or torque reaction during start-up.** *The operator can control torque reactions or kickback forces, if proper precautions are taken.*
- **Never place your hand near the rotating accessory.** *Accessory may kickback over your hand.*
- **Do not position your body in line with the rotating wheel.** *Kickback will propel the tool in direction opposite to the wheel's movement at the point of snagging.*
- **Use special care when working corners, sharp edges etc. Avoid bouncing and snagging the accessory.** *Corners, sharp edges or bouncing have a tendency to snag the rotating accessory and cause loss of control or kickback.*
- **Do not attach a saw chain, woodcarving blade, segmented diamond wheel with a peripheral gap greater than 10 mm or toothed saw blade.** *Such blades create frequent kickback and loss of control.*
- **Do not "jam" the wheel or apply excessive pressure. Do not attempt to make an excessive depth of cut. Overstressing the wheel increases the loading and susceptibility to twisting or binding of the wheel in the cut and the possibility of kickback or wheel breakage.**
- **When wheel is binding or when interrupting a cut for any reason, switch off the power tool and hold the power tool motionless until the wheel comes to a complete stop. Never attempt to remove the wheel from the cut while the wheel is in motion otherwise kickback may occur. Investigate and take corrective action to eliminate the cause of wheel binding.**
- **Do not restart the cutting operation in the workpiece. Let the wheel reach full speed and carefully re-enter the cut.** *The wheel may bind, walk up or kickback if the power tool is restarted in the workpiece.*

- **Support panels or any oversized workpiece to minimize the risk of wheel pinching and kickback.** *Large workpieces tend to sag under their own weight. Supports must be placed under the workpiece near the line of cut and near the edge of the workpiece on both sides of the wheel.*
- **Use extra caution when making a "pocket cut" into existing walls or other blind areas.** *The protruding wheel may cut gas or water pipes, electrical wiring or objects that can cause kickback.*



## 5 SYMBOLS ON THE PRODUCT

Some of the following symbols may be used on this product. Please study them and learn their meaning. Proper interpretation of these symbols will allow you to operate the product better and safer.

Symbol	Explanation
	Direct current-Type or characteristic of current.
	Precautions that involve your safety.
	Read and understand all instructions before operating the product, and follow all warnings and safety instructions.
	Wear eye and ear protection, wear a hard hat wherever there is any risk of falling objects.
	Risk of dust emission - danger for health!
	DANGER! Be careful with kickbacks.
	Risk of fire or explosion.
	Never use damaged cut-off wheel and saw blades, these may cause fatal injuries!
	Wear non-slip, heavy duty gloves.
	Wear sturdy, snug-fitting clothing.
	Wear safety footwear.

6 RISK LEVELS

The following signal words and meanings are intended to explain the levels of risk associated with this product.

SYM-BOL	SIGNAL	MEANING
	DANGER	Indicates an imminently hazardous situation, which, if not avoided, will result in death or serious injury.
	WARNING	Indicates a potentially hazardous situation, which, if not avoided, could result in death or serious injury.
	CAUTION	Indicates a potentially hazardous situation, which, if not avoided, may result in minor or moderate injury.
	CAUTION	(Without Safety Alert Symbol) Indicates a situation that may result in property damage.

7 ENVIRONMENTALLY SAFE BATTERY DISPOSAL



The toxic and corrosive materials below are in the batteries used in this machine: **Lithium-ion, a toxic material.**

▲ WARNING

Discard all toxic materials in a specified manner to prevent contamination of the environment. Before discarding damaged or worn out Li-ion battery, contact your local waste disposal agency, or the local Environmental Protection Agency for information and specific instructions. Take the batteries to a local recycling and/or disposal center, certified for lithium-ion disposal.

▲ WARNING

If the battery pack cracks or breaks, with or without leaks, do not recharge it and do not use. Discard it and replace with a new battery pack. **DO NOT TRY TO REPAIR IT!** To prevent injury and risk of fire, explosion, or electric shock, and to avoid damage to the environment:

- Cover the terminals of the battery with heavy-duty adhesive tape.
- **DO NOT** try to remove or destroy any of the battery pack components.
- **DO NOT** try to open the battery pack.
- If a leak develops, the released electrolytes are corrosive and toxic. **DO NOT** get the solution in the eyes or on skin, and do not swallow it.
- **DO NOT** put these batteries in your regular household trash.
- **DO NOT** incinerate.
- **DO NOT** put them where they will become part of any waste landfill or municipal solid waste stream.
- Take them to a certified recycling or disposal center.

8 PROPOSITION 65

▲ WARNING

This product contains a chemical known to the state of California to cause cancer, birth defects or other reproductive harm. Some dust created by power sanding, sawing, grinding, drilling, and other construction activities contains chemicals known to cause cancer, birth defects or other reproductive harm. Some examples of these chemicals are:

- Lead from lead-based paints;
- Crystalline silica from bricks and cement and other masonry products;
- Arsenic and chromium from chemically treated lumber.

Your risk of exposure to these chemicals varies depending on how often you do this type of work. To reduce your exposure to these chemicals, work in a well-ventilated area, and work with approved safety equipment, such as dust masks that are specially designed to filter out microscopic particles.

9 SAVE THESE INSTRUCTIONS

10 INSTALLATION

▲ WARNING

Do not change or use accessories that are not recommended by the manufacturer.

**▲ WARNING**

Do not install battery pack until you assemble all the parts.

**10.1 UNPACK THE MACHINE****▲ WARNING**

Make sure that you correctly assemble the machine before use.

**▲ WARNING**

- If parts of the machine are damaged, do not use the machine.
- If you do not have all the parts, do not operate the machine.
- If parts are damaged or missing, contact the service center.

1. Open the package.
2. Read the documentation provided in the box.
3. Remove all the unassembled parts from the box.
4. Remove the machine from the box.
5. Discard the box and packing material in compliance with local regulations.

**▲ WARNING**

For your personal safety, do not insert battery before the tool is assembled completely.

**10.2 INSTALL THE WHEEL****▲ CAUTION**

Wear adequate clothing, gloves and goggles before touching the wheel.

**▲ CAUTION**

The composite abrasive wheel is suitable for steel materials; the diamond abrasive wheel is suitable for concrete materials.

**▲ WARNING**

Note the arrows on the guard indicating the direction of rotation. Make sure the wheel is fitted in the same direction.

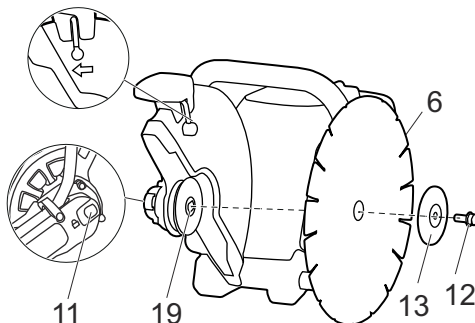

1. Press and hold the spindle lock button (11).
2. Remove the washer (13) and screw (12).
3. Fit the wheel (6), washer (13) and screw (12).

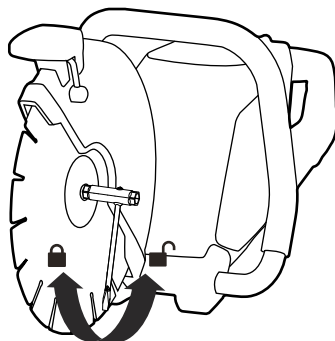

4. Tightening the screw with 18.5 ft-lbs.

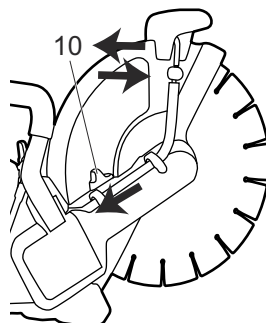
**10.3 ADJUST THE ANGLE OF GUARD**

The guard can be adjusted to different angles.

1. Pull the guard adjustment lever (10) rearward and hold it.
2. Move the guard to the desired angle.
3. Release the guard adjustment lever.



## 10.4 INSTALL THE BATTERY PACK

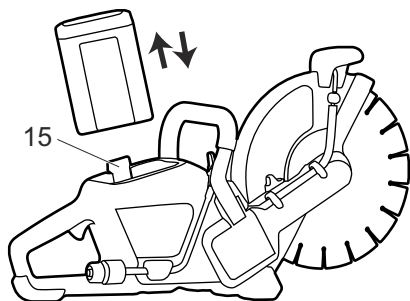

### ⚠ WARNING

- If the battery pack or charger is damaged, replace the battery pack or the charger.
- Stop the machine and wait until the motor stops before you install or remove the battery pack.
- Read and understand the instructions in the battery and charger manual.

1. Align the lift ribs on the battery pack with the grooves in the battery compartment.
2. Push the battery pack into the battery compartment until the battery pack locks into place.
3. When you hear a click, the battery pack is installed.

## 10.5 REMOVE THE BATTERY PACK

1. Push and hold the battery release button (15).
2. Remove the battery pack from the machine.

## 11 OPERATION

### i IMPORTANT

Before you operate the machine, read and understand the safety regulations and the operation instructions.

### ⚠ WARNING

Be careful when you operate the machine.

## 11.1 SPECIFIC SAFETY WARNINGS

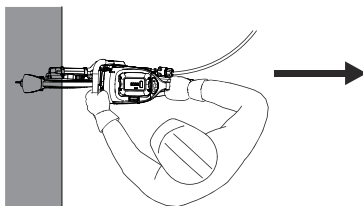
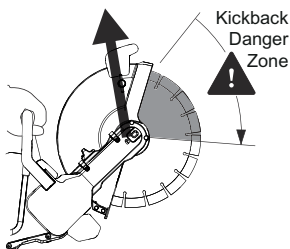

- Danger of kickback – Kickback can result in fatal injuries. Kickback occurs when the cut-off machine is suddenly thrown up and back in an uncontrolled arc towards the operator. Refer to the safety section for detailed information about kickback.
- Do not stand in line with the abrasive wheel. Ensure sufficient freedom of movement, especially in construction trenches there must be sufficient space for the user and for the part being cut to fall. Do not lean too far forward and never bend over the abrasive wheel.
- Frequently inspect the cutting wheel – replace it right away if there are visible cracks, buckling or other damage (for example, overheating) – risk of accident or death due to breakage!

## 11.2 HOLD THE MACHINE

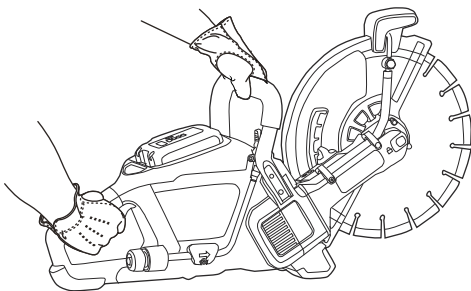

1. Hold the machine with one hand at the rear handle and with the other hand at the front handle. Always use both hands when using the machine.
2. Hold the handles with the thumbs and the fingers around them.
3. Make sure that the thumb of the hand that holds the front handle is below the handle.

## 11.3 START THE MACHINE

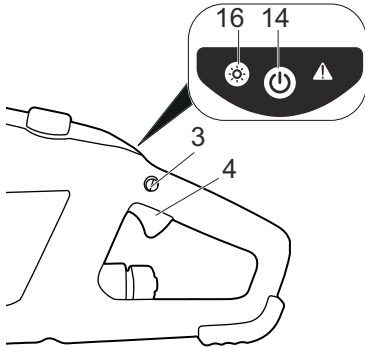

1. Press the on/off button (14).
2. Press the lock-out button (3).
3. Press the trigger (4) while you hold the lock-out button.

## 11.4 STOP THE MACHINE

1. Release the trigger to stop the machine.

## 11.5 LED LIGHT

The LED light illuminates when the switch is depressed. It provides extra light for increased visibility.

1. Press the light button (16) to turn on the LED light (17).

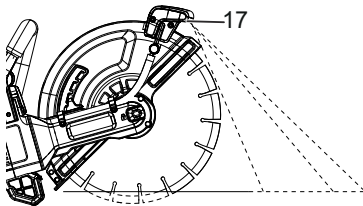

2. It can light up the work area and provide a cutting line.
3. Press the light button again to turn off the LED light.

## 11.6 FUNCTION OF CONTROL PANEL

ON/OFF button

- 1 push – power on/off.
- 1 minute delay of inactivity – power turns off .
- If light is on. 1 minute delay of inactivity – stand by.

Light button

- When power is on 1 push – light on/off .
- 10 minutes delay of inactivity – light turns off .

- Last minute of delay flashes will occur before light turns off .

## 11.7 CONNECT THE WATER SUPPLY

### ⚠ WARNING

Wet cutting is used only with the diamond abrasive wheel when cutting concrete.

### ⚠ WARNING

Follow the instruction on the cutting equipment before applying water.

### ⚠ CAUTION

In sub-zero temperature, the water must be drained out from the pipe after finishing work to avoid the risk of freezing.

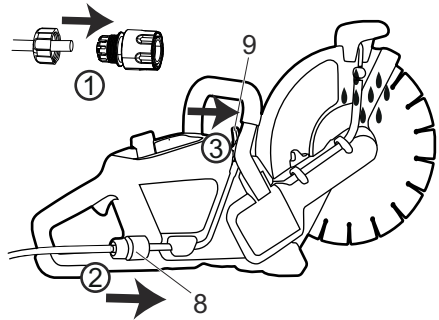

1. Assemble the water supply to the connector.
2. Connect coupling (8) to the machine.
3. Adjust the water flow by the adjuster (9). After work, stop the machine and close the water supply.

### i NOTE

Do not cut after closing the water supply. The concrete grout can block the water outlet.

4. Disconnect the water supply from the connector.

## 12 MAINTENANCE

### ⚠ CAUTION

Do not let brake fluids, gasoline, petroleum-based materials touch the plastic parts. Chemicals can cause damage to the plastic, and make the plastic unserviceable.

### ⚠ CAUTION

Do not use strong solvents or detergents on the plastic housing or components.

**▲ WARNING**

Remove the battery pack from the machine before maintenance.

**12.1 REPLACE THE WHEEL****▲ WARNING**

Use only approved replacement blades.

**▲ CAUTION**

Wear adequate clothing, gloves and goggles before touching the wheel.

1. Stop the machine.
2. Press and hold the spindle lock button (11).

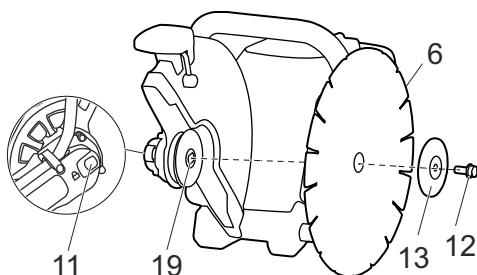

3. Remove the wheel (6), washer (13) and screw (12).

**i NOTE**

The machine applies to two sizes (0.8"/1") of wheel bore. You can change to the other size via turning over the shaft sleeve (19).

4. Fit the new wheel, washer and screw.

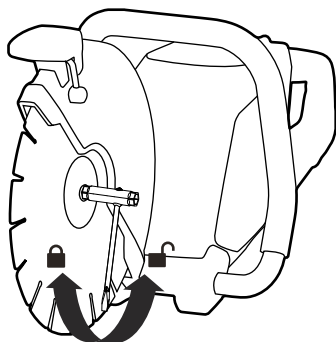

5. Tightening the screw with 18.5 ft-lbs.

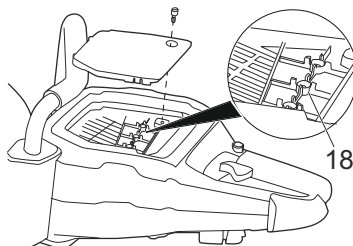
**12.2 CLEAN THE MACHINE**

- Remove the battery pack from the machine before cleaning.
- Check and clean the magnet filter (18) after every working shift cutting in metal.
- Clean the machine after use with a moist cloth dipped in neutral detergent.
- Do not use aggressive detergents or solvents to clean the plastic parts or handles.
- Keep the air vents clean and free of debris to avoid overheating and damage to the motor or the battery.
- Never clean the battery or the machine with a water hose or a pressure washer.

**13 TRANSPORTATION AND STORAGE**

Before you move the machine, always:

- Remove the battery pack from the machine.
- Keep hands clear of the switch.

Before you put the machine into storage, always:

- Remove the battery pack from the machine.
- Make sure to clean the machine before storage.
- Make sure that the storage area is:
  - Not available to children.
  - Away from agents which can cause corrosion, such as garden chemicals and de-icing salts.

## 14 TROUBLESHOOTING

Problem	Possible cause	Solution
The motor runs but the wheel does not rotate.	The wheel is too loose.	Make sure the screw is tightened with correct torque (See figure 3).
	The wheel is damaged and cannot rotate.	Check the blade guard and remove unwanted material after that see if the blade runs free.
	The motor is damaged.	<ol style="list-style-type: none"> <li>1. Remove the battery pack from the machine.</li> <li>2. Remove the wheel.</li> <li>3. Clean the machine.</li> <li>4. Install battery pack and operate the machine.</li> <li>5. Call service center if the fault appears again.</li> </ol>
The motor runs and the blade rotates, but it does not cut.	The wheel is dull.	Replace the cutting wheel.
	The wheel is in the incorrect direction.	Follow the instructions of the cutting wheel of how to mount it on machine.
	The wheel is tight or loose.	Make sure the screw is tightened with 18.5 ft-lbs in torque.
The machine does not start.	The machine and battery are not connected correctly.	Make sure that the battery release button clicks when you install the battery pack.
	The battery level is low.	Charge the battery pack.
	The battery is too hot or too cold.	Refer to battery and charger manual.
Warning light flashes one time.	Motor low speed protection	Release the trigger and start the machine again.
Warning light flashes two times.	Self-test failure of controller	<ol style="list-style-type: none"> <li>1. Install the battery pack again.</li> <li>2. Replace the controller if the fault appears again.</li> </ol>
Warning light flashes three times.	Battery pack communication failure	<ol style="list-style-type: none"> <li>1. Install the battery pack again.</li> <li>2. Replace the controller if the fault appears again.</li> </ol>
Warning light flashes four times.	Overcurrent protection	Release the trigger and start the machine again.
Warning light flashes five times.	Low-voltage protection	Charge the battery pack.
Warning light flashes six times.	Controller over-temperature protection	Cool the controller to ambient temperature.
Warning light flashes seven times.	Blocking protection or communication failure of hall	<ol style="list-style-type: none"> <li>1. Release the trigger and start the machine again.</li> <li>2. Replace the controller if the fault appears again.</li> </ol>
Warning light flashes eight times.	Switch logic error	<ol style="list-style-type: none"> <li>1. Release the trigger and start the machine again.</li> <li>2. Replace the controller if the fault appears again.</li> </ol>

Problem	Possible cause	Solution
Warning light flashes nine times.	Software authentication error	1. Install the battery pack again. 2. Replace the controller if the fault appears again.
Warning light flashes ten times.	Motor over-temperature protection	Cool the controller to ambient temperature.
Warning light flashes eleven times.	Battery temperature is too high.	Cool the battery pack to ambient temperature.

15 TECHNICAL DATA

Voltage	82 V DC
No load speed	269 ft/s (82 m/s)
Wheel outside diameter	12" (300 mm)
Wheel bore diameter	0.8"(20 mm)/1"(25.4 mm)
Wheel tightening torque	18.5 ft-lbs
Max. depth of cut	4.33" (110 mm)
Max. pressure of water supply	6 bar
Weight (without battery pack)	12.6 lbs (5.7 kg)
Measured sound pressure level	L <sub>pA</sub> = 98 dB(A), K <sub>pA</sub> = 3 dB(A)
Guaranteed sound power level	L <sub>WA,d</sub> = 114 dB(A)
Vibration (main handle)	< 2.5 m/s <sup>2</sup> , K = 1.5 m/s <sup>2</sup>
Vibration (auxiliary handle)	2.6 m/s <sup>2</sup> , K = 1.5 m/s <sup>2</sup>
Approved battery models	GL400BT, 82BD250, 82BD400, 82BD500, 82BD800
Charger model	GC 400, 82DPC8A, 82CH62K and other Greenworks Commercial 82V Chargers

16 LIMITED WARRANTY



Greenworks hereby warranties this product, to the original purchaser with proof of purchase, 2-year commercial power train warranty, 2-year commercial battery warranty against defects in materials, parts or workmanship. Greenworks, at its own discretion will repair or replace any and all parts found to be defective,

free of charge to the customer. This warranty is valid only for units which have been used for personal or commercial use and that have been maintained in accordance with the instructions in the owners' manual supplied with the product from new.

2-YEAR LIMITED POWER TRAIN WARRANTY COVERAGE:

- Motor
- PCB Boards
- Gear Box
- 2 years from the date of purchase (non transferable)

2-YEAR LIMITED BATTERY WARRANTY COVERAGE:

- Greenworks Commercial Battery Packs (82BD250, 82BD400, 82BD500, 82BD800 and other GL or 82BD series)
- 2 year from the date of purchase (non transferable)

60-DAY LIMITED WEARABLE PARTS WARRANTY COVERAGE:

- Bars
- Blades
- Guards
- Chains
- Bump Feed Heads
- Tines
- Auger Bit
- Adaptor
- Extender
- 60 Days from date of purchase (non transferable)

WARRANTY EXCLUSIONS, LIMITATIONS AND RIGHTS:

1. All warranties may not be transferred by the consumer to any subsequent purchaser.
2. Parts or components not supplied by the warrantor, or parts or components that have been modified.

3. Any failure resulting from the use of improper tools or improper repair procedures.
4. Any failure resulting from the use of improper tools or improper repair procedures.
5. Any failure or part that has become inoperative due to accident, impact, abuse, misuse, neglect, mishandling, dulling of cutting edges, or failure to operate the product in accordance with the information provided in the instruction manual supplied with the product.
6. Routine maintenance items such as lubricants, blade sharpening.
7. The unit, if it has not been operated and/or maintained in accordance with the owner's manual.

[www.greenworksaustralia.com](http://www.greenworksaustralia.com)



**greenworks**  
COMMERCIAL  
xxxxxxxxxx Rev B