

# greenworks®

ST1606

EN

STRING TRIMMER & BRUSH CUTTER

OPERATOR MANUAL

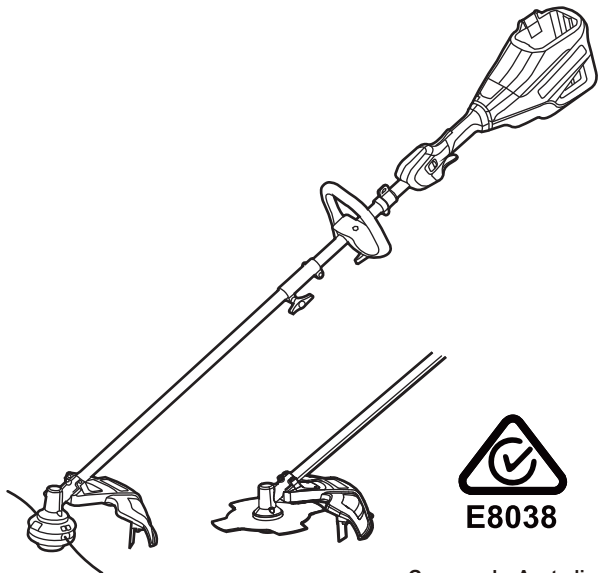

Greenworks Australia  
A Division Jak Max P/L  
380 Foley's Road Derrimut  
Victoria, Australia 3026

[www.greenworksaustralia.com](http://www.greenworksaustralia.com)



<b>1</b>	<b>Introduction.....</b>	<b>2</b>	6.1	Examine the battery and the battery charger.....	9
1.1	Product description.....	2	6.2	Clean the product, the battery, and the battery charger.....	9
1.2	Intended use.....	2	6.3	Replace the spool.....	9
1.3	Product overview.....	2	6.4	Install the cutting line.....	10
1.4	Symbols on the product.....	2	6.5	Remove the trimmer head.....	10
<b>2</b>	<b>Safety.....</b>	<b>3</b>	6.6	Install the trimmer head.....	11
2.1	Safety definitions.....	3	6.7	Remove the brush cutter blade.....	11
2.2	Important safety instructions.....	3	6.8	Install the brush cutter blade.....	12
2.3	Inspect safety features.....	4	<b>7</b>	<b>Transportation, storage, and disposal.....</b>	<b>12</b>
<b>3</b>	<b>Service.....</b>	<b>5</b>	7.1	Transportation and storage.....	12
<b>4</b>	<b>Assembly.....</b>	<b>5</b>	7.2	Disposal of the battery, battery charger, and product.....	12
4.1	Install the Trimmer guard.....	5	<b>8</b>	<b>Troubleshooting.....</b>	<b>14</b>
4.2	Assemble the shaft.....	5	<b>9</b>	<b>Technical data.....</b>	<b>15</b>
4.3	Install the auxiliary handle.....	6	<b>10</b>	<b>Warranty.....</b>	<b>16</b>
<b>5</b>	<b>Operation.....</b>	<b>6</b>			
5.1	Before you use the product.....	6			
5.2	Operate the product.....	7			
5.3	Stop the product.....	8			
<b>6</b>	<b>Maintenance.....</b>	<b>9</b>			



## 1 INTRODUCTION

### 1.1 PRODUCT DESCRIPTION

This product is a battery-operated string trimmer/brush cutter with an electrical motor.

We are committed to continuously improving our products, and reserve the right to modify the design and appearance without prior notice.

### 1.2 INTENDED USE

This product is designed to cut, trim, and clear different types of vegetation using the brush cutter blade or the trimmer head. It should not be used for any other tasks.

Please note that national or local regulations may regulate the use of the product. It is important to comply with any regulations given.

Always use accessories that are approved by the manufacturer with this product.

### 1.3 PRODUCT OVERVIEW

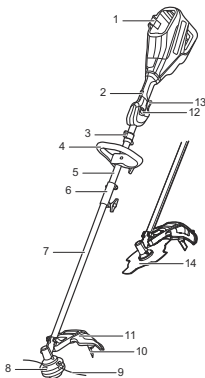

- 1 Battery release button
- 2 Safety-lock button
- 3 Strap bracket
- 4 Auxiliary handle
- 5 Upper shaft
- 6 Coupler
- 7 Lower shaft
- 8 Trimmer head
- 9 Cutting line

- 10 String cut-off blade
- 11 Trimmer guard
- 12 Speed switch
- 13 Trigger
- 14 Brush cutter blade

### 1.4 SYMBOLS ON THE PRODUCT

Some of the following symbols may be used on this tool. Please study them and learn their meaning. Proper interpretation of these symbols will allow you to operate the tool better and safer.

Symbol	Explanation
	Read and understand all instructions before operating the product, follow all warnings and safety instructions.
	Wear head protection.
	Wear eye and ear protection.
	Wear safety footwear.
	Wear protective gloves.
	Do not expose the product to rain or moist conditions.
	Be aware of blade thrust.
	Thrown objects can ricochet and result in personal injury or property damage. Wear protective clothing and boots.
	Do not use saw blades.
	Beware of thrown or flying objects. Keep all bystanders, especially children and pets, at a safe distance at least 15 m away from the operating area.
	Keep bystanders a safe distance away from the product.



## 2 SAFETY

### 2.1 SAFETY DEFINITIONS

Warnings, cautions, and notes are used to point out especially important parts of the manual.



#### WARNING

**THERE IS A RISK OF INJURY OR DEATH FOR THE OPERATOR OR BYSTANDERS IF THE INSTRUCTIONS IN THE MANUAL ARE NOT OBEYED.**



#### CAUTION

**THERE IS A RISK OF DAMAGE TO THE PRODUCT, OTHER MATERIALS, OR THE ADJACENT AREA, IF THE INSTRUCTIONS IN THE MANUAL ARE NOT OBEYED.**

**Note:** Used to give more information that is necessary in a given situation.

### 2.2 IMPORTANT SAFETY INSTRUCTIONS

**READ ALL INSTRUCTIONS BEFORE USING (THIS POWER TOOL)**



#### WARNING

**READ AND UNDERSTAND ALL INSTRUCTIONS BEFORE USING THIS PRODUCT. FAILURE TO FOLLOW ALL INSTRUCTIONS LISTED BELOW MAY RESULT IN ELECTRIC SHOCK, FIRE, AND/OR SERIOUS PERSONAL INJURY.**

- Use only identical manufacturer's replacement parts and accessories. Use of any other parts may create a hazard or cause product damage.
- Always wear safety glasses with side shields marked to comply with ANSI Z87.1. Everyday glasses have only impact resistant lenses. They are NOT safety glasses. Following this rule will reduce the risk of eye injury. Use face mask if operating in dusty workspaces.
- Avoid Dangerous Environment – Don't expose power tools to damp or wet conditions. Water entering a power tool will increase the risk of electric shock.
- Don't use in rain.
- Keep all bystanders, children, and pets at least 50 ft. away.
- Dress Properly – Do not wear loose clothing or jewelry. They can be caught in moving parts. Use of protective gloves and footwear is recommended when working outdoors. Wear protective hair covering to contain long hair.
- Use right Appliance. Do not use appliance for any job except that for which it is intended.
- Avoid Unintentional Starting – Avoid having any fingers on the power switch when the unit has a battery inserted and is not in use. Carrying this unit with a finger on the switch when the battery is inserted increases likelihood of an accident.
- Don't Force Appliance – It will do the job better and with less likelihood of a risk of injury at the rate for which it was designed.
- Don't overreach – Keep proper footing and balance at all times.
- Stay alert – Watch what you are doing. Use common sense. Do not operate this unit when you are tired, ill or under the influence of alcohol, drugs, or medication.
- Always store idle power tools indoors – When not in use, power tools should be stored indoors in a dry and high or locked-up place, out of reach of children.
- The machine is not intended for use by persons (including children) with reduced physical, sensory, or mental capabilities, or lack of experience and knowledge, unless they have been given supervision or instruction concerning use of the machine by a person responsible for their safety. Children should be supervised to ensure that they do not play with the machine.
- Maintain Appliance With Care – Replace string head if cracked, chipped, or damaged in any way. Be sure the string head is properly installed and securely fastened. Keep cutting edge sharp and clean for best performance and to reduce the risk of injury. Follow instructions for lubricating and changing accessories. Inspect appliance cord periodically, and if damaged, have it repaired by an authorized service facility. Inspect extension cords periodically and replace if damaged. Keep handles dry, clean, and free from oil and grease. Failure to do so can cause serious injury.
- Check damaged parts before using the appliance, a guard or other part that is damaged should be carefully checked to determine that it will operate properly and perform its intended function. Check for alignment of moving parts, binding of moving parts, breakage of parts, damaged mountings, and any other condition that may affect its operation. A guard or other part that is damaged should be properly repaired or replaced by an authorized service center unless indicated elsewhere in this manual.
- Remove or disconnect battery before servicing, cleaning, or removing material from the gardening appliance.
- Do not modify or attempt to repair the appliance or the battery pack (as applicable) except as indicated in the instructions for use and care. Use appliances only with specifically designated battery packs. Use



of any other battery packs may create a risk of injury and fire. Use only with Greenworks G60B2/G60B3/G60B4/G60B4 battery or other BAC series.

- Recharge only with the charger specified by the manufacturer. A charger that is suitable for one type of battery pack may create a risk of fire when used with another battery pack. Use only with Greenworks G60UC charger or other CAC series.
- When battery pack is not in use, keep it away from other metal objects, like paper clips, coins, keys, nails, screws, or other small metal objects, that can make a connection from one terminal to another. Shorting the battery terminals together may cause a fire.
- Under abusive conditions, liquid may be ejected from the battery; avoid contact. If contact accidentally occurs, flush with water. If liquid contacts eyes, additionally seek medical help. Liquid ejected from the battery may cause irritation or burns.
- Do not use a battery pack or appliance that is damaged or modified. Damaged or modified batteries may exhibit unpredictable behavior resulting in fire, explosion, or risk of injury.
- Do not expose a battery pack or appliance to fire or excessive temperature. Exposure to fire or temperature above 265 °F (130 °C) may cause an explosion.
- Do not dispose of the batteries in a fire. The cells may explode. Check with local codes for possible special disposal instructions.
- Do not open or mutilate the batteries. Released electrolyte is corrosive and may cause damage to the eyes or skin. It may be toxic if swallowed.
- Exercise care in handling batteries in order not to short the battery with conducting materials such as rings, bracelets, and keys. The battery or conductor may overheat and cause burns.
- Follow all charging instructions and do not charge the battery pack or appliance outside of the temperature range specified in the instructions. Charging improperly or at temperatures outside of the specified range may damage the battery and increase the risk of fire.
- Have servicing performed by a qualified repair person using only identical replacement parts. This will ensure that the safety of the product is maintained.
- Keep guards in place and in working order.
- Keep hands and feet away from cutting area.
- Disconnect the battery pack from the appliance before making any adjustments, changing accessories, or storing appliance. Such preventive safety measures reduce the risk of starting the appliance accidentally.
- Use only with nylon cutting line with a max diameter of 2.0 mm/2.4 mm . Do not use heavier lines

than recommended by the manufacturer and line materials of other types – for example, metal wire, rope, and the like.

## SAVE THESE INSTRUCTIONS

### 2.3 INSPECT SAFETY FEATURES

#### WARNING

**ALWAYS REFER TO THIS SAFETY INSPECTION LIST BEFORE AND AFTER OPERATING THE PRODUCT.**

- Examine the work area to identify any potential hazards, such as uneven terrain, slopes, rocks, branches, or ditches.
- Perform all required safety inspections, maintenance, and servicing as specified in this manual.
- Check that all covers, guards, handles, and cutting equipment is properly attached and undamaged.
- Inspect the brush cutter blade for cracks, especially around the bottom teeth and the center hole. Replace the blade if it is damaged.
- Examine the support flange for cracks, damage, and replace if necessary.
- Ensure that the locknut is not loose and that it has a locking force of at least 1.5 N.m. Tighten the locknut to a torque of between 35-50 N.m.

#### 2.3.1 CHECK THE SAFETY-LOCK BUTTON AND TRIGGER

The safety-lock button is designed to prevent accidental operation. *See **Product overview** to find where these parts are located on your product.*

1. Make sure that the trigger is locked when the safety-lock button is not pressed.
2. Make sure that the trigger and safety-lock button move freely and that the return spring works correctly.
3. Simultaneously push the safety-lock button and pull the trigger to start the product.
4. Test on high-speed mode.
5. Release the trigger and make sure that the cutting attachment stops completely.

#### 2.3.2 CHECK CUTTING ATTACHMENT GUARD

The cutting attachment guard is a crucial safety device that prevents objects from being thrown towards the operator and prevents injury if the cutting attachment is touched.



**⚠ WARNING**

**DO NOT USE A CUTTING ATTACHMENT WITHOUT AN APPROVED AND CORRECTLY ATTACHED CUTTING ATTACHMENT GUARD. ALWAYS USE THE RECOMMENDED CUTTING ATTACHMENT GUARD FOR THE CUTTING ATTACHMENT THAT YOU USE. USING AN INCORRECT OR FAULTY CUTTING ATTACHMENT GUARD CAN CAUSE SERIOUS PERSONAL INJURY.**

1. Stop the product and remove the battery.
2. Visually inspect for damage, such as cracks.
3. Replace the cutting attachment guard if it is damaged.

**3 SERVICE**

Servicing requires extreme care, and knowledge and must be performed only by a qualified service technician. Consult your nearest **AUTHORIZED SERVICE CENTER** for repair. Call 1-855-345-3934 to obtain the address. Only use identical manufacturer's replacement parts and accessories from the **AUTHORIZED SERVICE CENTER**.

**4 ASSEMBLY**

This section describes how to assemble and adjust the product.

**⚠ WARNING**

**CAREFULLY READ AND UNDERSTAND THE SAFETY CHAPTER AND THE ASSEMBLY INSTRUCTIONS BEFORE YOU ASSEMBLE THE PRODUCT.**

**4.1 INSTALL THE TRIMMER GUARD****⚠ WARNING**

- **THE STRING CUT-OFF BLADE MUST ALWAYS BE EQUIPPED ON THE TRIMMER GUARD BEFORE OPERATING THE PRODUCT.**
- **DO NOT TOUCH THE STRING CUT-OFF BLADE.**

1. Remove the screws from the trimmer guard with a Phillips head screwdriver (not included).
2. Place the trimmer guard onto the shaft.
3. Securely tighten the screws with a Phillips head screwdriver.

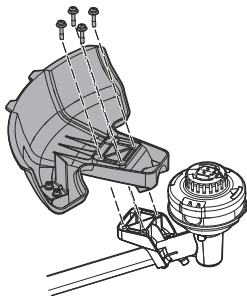
**4.2 ASSEMBLE THE SHAFT**

1. Loosen the knob on the coupler.

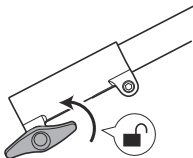

2. Push in the release button (1) on the lower shaft.
3. Align the release button with the mounting hole (2) and slide the two shafts together.

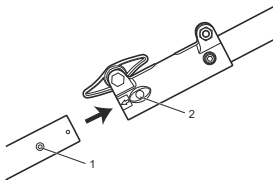
**⚠ CAUTION**

**EXERCISE CAUTION WHILE SLIDING THE TWO SHAFTS TOGETHER TO PREVENT ANY RISK OF PINCHING YOUR HANDS OR FINGERS.**

4. Turn the lower shaft until the button locks into the mounting hole.
5. Securely tighten the knob.



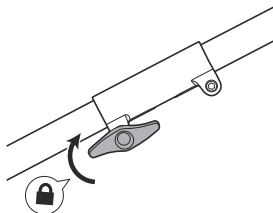

**Note:** When properly assembled, the upper and lower shaft should not separate when pulled.

**⚠ WARNING**

**CAREFULLY FOLLOW THE ASSEMBLY INSTRUCTIONS AS DESCRIBED ABOVE. FAILURE TO DO SO MAY LEAD TO THE PRODUCT SEPARATING, WHICH INCREASES THE RISK OF PERSONAL INJURY.**

#### 4.3 INSTALL THE AUXILIARY HANDLE

1. Install the auxiliary handle on the shaft.

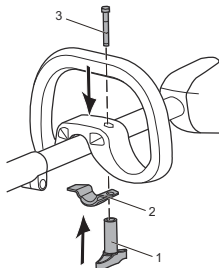

2. Place the lower clamp (2) into the slot on the auxiliary handle.
3. Install the bolt (3) and the knob (1). Do not fully tighten.

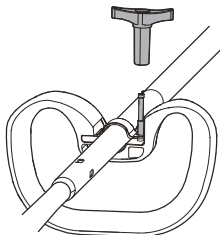

4. Adjust the auxiliary handle to desired position.
5. Securely tighten the knob onto the bolt.

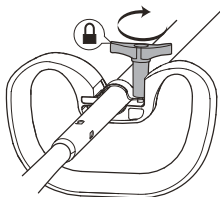

#### 5 OPERATION

This section describes how to operate the product.

**⚠ WARNING**

**CAREFULLY READ AND UNDERSTAND THE SAFETY CHAPTER AND OPERATION INSTRUCTIONS BEFORE YOU OPERATE THE PRODUCT.**

##### 5.1 BEFORE YOU USE THE PRODUCT

###### 5.1.1 CONNECT THE BATTERY CHARGER

Connect the battery charger to the proper voltage and frequency that is specified on the rating plate.

Refer to the Battery Charger Operator Manual for information about how to use the battery charger.

###### 5.1.2 CHARGE THE BATTERY

Refer to the Battery Charger Operator Manual for information about how to use the battery charger.

###### 5.1.3 BATTERY INFORMATION

Refer to the Battery Operator Manual for information about how to use the battery.



### 5.1.4 CONNECT THE BATTERY TO THE PRODUCT



**WARNING**

**ONLY USE THE ORIGINAL BATTERY WITH THE PRODUCT.**

1. Make sure that the battery is fully charged.
2. Push the battery into the battery compartment. The battery locks into position when you hear a click.

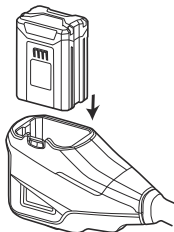

**CAUTION**

**IF THE BATTERY DOES NOT FIT EASILY INTO THE BATTERY HOLDER, IT MAY NOT BE INSTALLED CORRECTLY, WHICH CAN CAUSE DAMAGE TO THE BATTERY AND/OR THE PRODUCT.**

3. Make sure that the battery is installed securely.

### 5.1.5 START THE PRODUCT

1. Simultaneously push the safety-lock button (1) and pull the trigger (2).

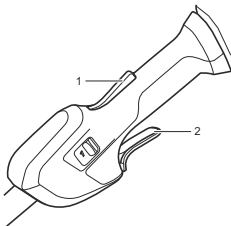

2. Adjust the speed according to the grass condition by sliding the speed switch.

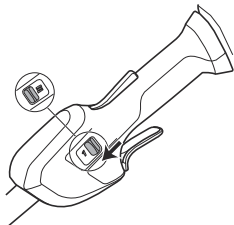

### 5.2 OPERATE THE PRODUCT

#### 5.2.1 ADJUST THE LENGTH OF THE CUTTING LINE

When the cutting line becomes short during operation, bump the trimmer head on a hard, flat surface to extend more cutting line out. It is recommended to operate the product on high-speed mode for dense work areas.

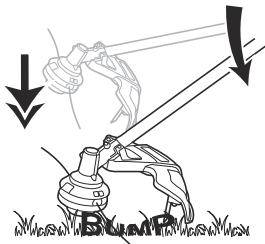

This trimmer is equipped with a string cut-off blade on the trimmer guard. The string cut-off blade continuously trims the line to ensure a consistent and efficient cutting diameter. This will maintain best performance and keep line long enough to advance properly.

#### 5.2.2 LINE CUT-OFF BLADE

This trimmer is equipped with a line cut-off blade on the guard. The line cut-off blade continuously trims the line to ensure a consistent and efficient cut diameter. Advance line whenever you hear the engine running faster than normal, or when trimming efficiency diminishes. This will maintain best performance and keep the line long enough to advance properly.



### 5.2.3 ADJUST THE CUTTING DIAMETER

**Note:** The cutting diameter of the product is set to 16 in. (40.6 cm), but it can be modified to 14 in. (35.6 cm) for longer runtime or kept at 16 in. (40.6 cm) for a larger cutting area.

1. First, start by removing the battery.
2. Unscrew the blade screws securing the string cut-off blade with the hex key.
3. Turn the string cut-off blade 180°.
4. Securely tighten the blade screws.

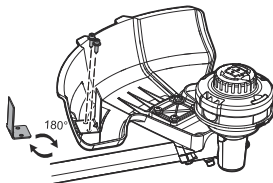

### 5.2.4 TRIM GRASS WITH A TRIMMER HEAD

#### Trim the grass

1. Hold the trimmer head above the ground at an angle. Do not push the cutting line into the grass.

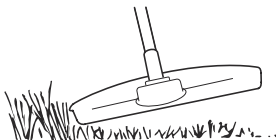

2. Decrease the speed to decrease the risk of damage to plants.
3. Use low-speed mode when cutting grass near objects.

#### Clear the grass

1. Keep the trimmer head above the ground.
2. Tilt the trimmer head.
3. Cut with the end of the cutting line around objects in the work area.



#### CAUTION

**OTHER OBJECTS THAT ARE HIT BY THE CUTTING LINE, INCREASE THE WEAR ON THE CUTTING LINE.**

4. Use low-speed mode when cutting and clearing vegetation. This decreases the wear on the trimmer head and cutting line.

### Cut the grass

1. Make sure that the cutting line is parallel to the ground.

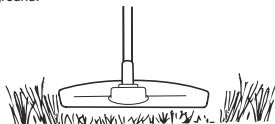

2. Do not push the trimmer head to the ground as this can cause damage to the product.
3. Move the product from side to side when you cut grass. Use high-speed mode for optimal performance.

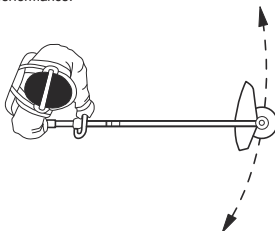

### Sweep the grass

The airflow from the rotating cutting line can be used to remove cut grass from an area.

1. Hold the trimmer head and the cutting line parallel to the ground and above the ground.
2. Use on high-speed mode.
3. Move the trimmer head from side to side to sweep the grass.

### 5.3 STOP THE PRODUCT

1. Release the trigger.
2. Push the battery release button and pull out the battery to fully stop its operation.



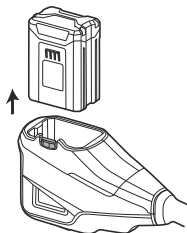

**⚠ WARNING**

**WAIT UNTIL THE MOTOR STOPS BEFORE YOU REMOVE THE BATTERY.**

## 6 MAINTENANCE

This section describes how to maintain the battery, battery charger, and product.

**⚠ WARNING**

**CAREFULLY READ AND UNDERSTAND THE SAFETY CHAPTER AND OPERATION INSTRUCTIONS BEFORE YOU DO ANY MAINTENANCE WORK.**

### Before you do maintenance:

- Stop the product.
- Remove the battery.
- Allow the motor to cool.
- Use correct clothing, protective gloves, and safety glasses.

### 6.1 EXAMINE THE BATTERY AND THE BATTERY CHARGER

Carefully inspect the battery, battery charger, and connection cord of the battery charger for any signs of damage, such as cracks or broken parts. Replace if necessary.

### 6.2 CLEAN THE PRODUCT, THE BATTERY, AND THE BATTERY CHARGER

- Clean the product after each use with a moist cloth and neutral detergent.
- Do not use strong detergents or solvents like "glass cleaner" to clean the plastic parts or handles.
- Keep the trimmer head free from grass, leaves, or excessive grease.
- Keep the air vents clean and free of debris to avoid overheating and damage to the motor.

- Do not spray water on the motor and electrical components.
- Clean the battery and battery charger with a dry cloth. Keep the battery guide tracks clean.
- Prior to inserting the battery into the battery charger, ensure that the terminals on both the battery and the battery charger are clean.

### 6.3 REPLACE THE SPOOL

1. Push the tabs (1) on the sides of the trimmer head at the same time.

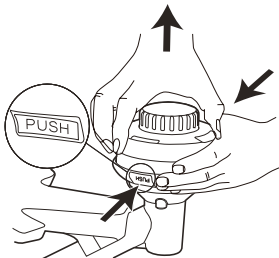

2. Pull and remove the spool cover (2).

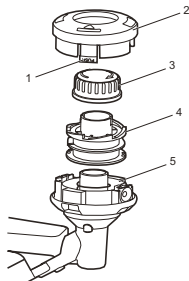

3. Remove the bump knob (3)
4. Remove any remaining line. Clean dirt and debris from all parts.
5. Replace the spool (4) if it is worn or damaged.
6. Put the new spool in the spool housing (5).

**Note:** Make sure that the cutting line is in the slot on the new spool and is extended approximately 6" (15 cm) before you install the new spool.

7. Put the ends of the cutting lines through the holes.



8. Extend the cutting line to release it from the guide slot in the spool.
9. Put the bump knob onto the spool.
10. Push the tabs and install the spool cover onto the spool housing.
11. Push the spool cover until it clicks into position.

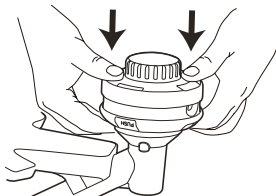

#### 6.4 INSTALL THE CUTTING LINE

**Note:** Do not use more than 15 ft. (4.6 m) of 2.0 mm/2.4 mm cutting line at a time.

1. Remove any leftover cutting line from the trimmer head.
2. Push and turn the spool cover. Ensure that the slot (1) on the bump head aligns with the slot on the spool cover.

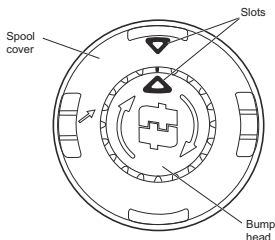

3. Feed the cutting line through the hole in the spool cover and push it until it exits the opposite hole.

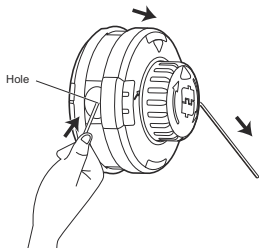

4. Pull the cutting line through until there is an equal amount of cutting line on each side.

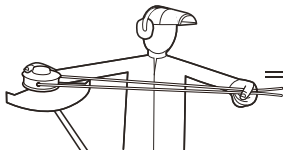

5. Turn the bump head clockwise to wind the cutting line into the trimmer head. Keep approximately 5" (13 cm) of cutting line above out of each side of the trimmer head.

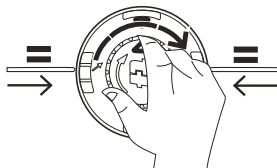

#### 6.5 REMOVE THE TRIMMER HEAD

1. Insert the metal rod (1) into the specified angle transmission hole (2), and hold in place.

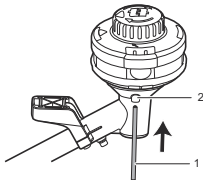



- Turn the trimmer head until the metal rod blocks rotation of the trimmer head.

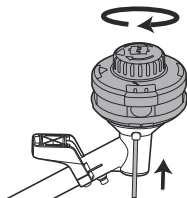

- Turn the trimmer head clockwise to remove it.

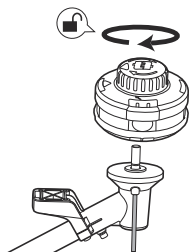

## 6.6 INSTALL THE TRIMMER HEAD

- Insert the metal rod (1) into the specified angle transmission hole (2), and hold in place. Turn the center shaft (3) until the metal rod blocks rotation of the shaft.

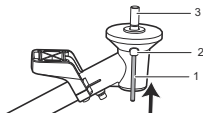

- Place the trimmer head onto the shaft.

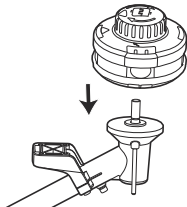

- Turn the trimmer head counterclockwise to securely tighten it.

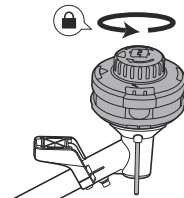

- Remove the metal rod.

## 6.7 REMOVE THE BRUSH CUTTER BLADE

- Insert the metal rod into the specified angle transmission hole, and hold in place. Turn the blade until the metal rod blocks rotation of the blade.
- Loosen the locknut clockwise and remove the outer cap.

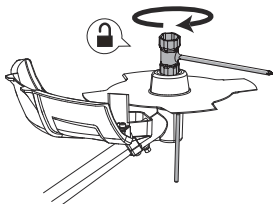

- Remove the support flange and brush cutter blade.

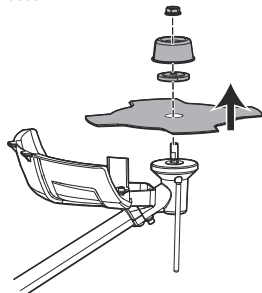



## 6.8 INSTALL THE BRUSH CUTTER BLADE

**⚠ WARNING**

- THE BRUSH CUTTER GUARD MUST BE INSTALLED BEFORE INSTALLING THE BRUSH CUTTER BLADE.
- WEAR PROTECTIVE GLOVES AND BE CAREFUL WITH SHARP EDGES.
- USE THE SPECIFIED LOCKNUT INCLUDED WITH THE BLADE, TO ASSEMBLE THE BLADE.

1. Insert the metal rod into the specified angle transmission hole, and hold in place. Turn the center shaft until the metal rod blocks rotation of the shaft.

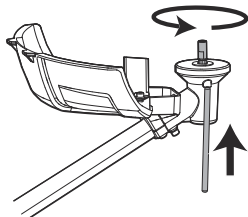

2. Arrange the brush cutter blade, support flange, outer cap, and locknut on the center shaft in the specified order.

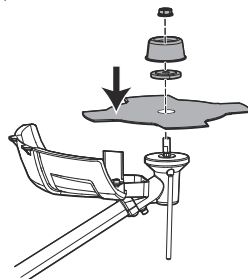

3. Tighten the locknut counterclockwise with the socket wrench, while firmly holding the metal rod in place.

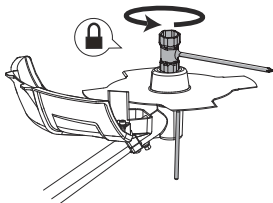

4. Remove the metal rod.

7 **TRANSPORTATION, STORAGE, AND DISPOSAL**7.1 **TRANSPORTATION AND STORAGE**

- Follow special packaging and labeling requirements for commercial transportation, including by third parties and forwarding agents.
- Seek advice from a person with special training in dangerous materials before shipping the product and comply with all applicable national regulations.
- Use tape on open contacts when packaging the battery and ensure it is securely packed to prevent movement.
- Remove the battery before storing or transporting the product.
- Store the battery and battery charger in a dry, moisture-free, and frost-free space.
- Avoid storing the battery in an area where static electricity may occur, and do not store in a metal box.
- Charge the battery 30% to 50% before long-term storage.
- Store the battery charger in a closed and dry space.
- Keep the battery away from the battery charger during storage, and ensure that unauthorized persons, including children, do not touch the equipment. Store the equipment in a lockable space.
- Clean the product and perform full servicing before long-term storage.
- Use transportation guards on the product to prevent injury or damage during transportation and storage.
- Securely stow the product during transport to ensure safe handling.

7.2 **DISPOSAL OF THE BATTERY, BATTERY CHARGER, AND PRODUCT**

Symbols on the product or the package of the product mean that the product is not domestic waste. Recycle it at a recycling station for electrical and electronic equipment. This helps to prevent damage to the environment and persons.



Greenworks Australia is a member of the B-Cycle Battery Recycling Program. Please dispose of your batteries responsibly and ethically. For more information on where to recycle your old batteries - please visit our website [greenworksaustralia.com](http://greenworksaustralia.com) or [ecobatt.net/drop-off-locations](http://ecobatt.net/drop-off-locations).



## 8 TROUBLESHOOTING

Problem	Possible Cause	Solution
The product does not start when the trigger is pulled.	No electrical contact between the product and the battery.	1. Remove the battery. 2. Inspect the metal contacts and re-insert the battery.
	The battery is depleted.	Charge the battery.
	The safety-lock button and trigger are not operated at the same time.	1. Push the safety-lock button and hold it. 2. Pull the trigger to start the product.
The product stops when you are cutting.	The guard is not attached to the cutting attachment.	Remove the battery and attach the guard to the cutting attachment.
	Blade is damaged.	Replace the blade (always wear protective gloves).
	Cutting line is too heavy.	Use only with the nylon cutting line of 2.0 mm/2.4 mm diameter.
	The grass becomes tangled around the motor shaft or the trimmer head.	1. Stop the product. 2. Remove the battery. 3. Remove the grass from the motor shaft and trimmer head.
	The motor is overloaded.	1. Remove the trimmer head from the grass. 2. The motor will recover as soon as the load is removed.
	The battery or product is too hot.	Allow the battery or product to cool down for at least 10 minutes.
	The battery is disconnected from the product.	Reinstall the battery.
	The battery is depleted.	Charge the battery.
The cutting line does not extend.	Lines are interlocked.	1. Remove the interlocked lines. 2. Rewind the lines.
	Not enough line on spool.	Install more line.
	Lines are worn too short.	1. Remove the battery. 2. Press and hold the bump head. 3. Pull out lines manually.
	Lines are tangled on spool.	1. Remove the lines from the spool. 2. Wind the lines.
The cutting line keeps breaking.	The product is used incorrectly.	1. Cut with the tip of the line, avoid stones, walls and other hard objects. 2. Advance the cutting line regularly to keep full cutting width.
Locknut cannot be removed to release the blade.	Damaged thread on nut/center shaft.	Lubricate the center shaft to aid removal.



Problem	Possible Cause	Solution
Blade fails to rotate.	Blade obstructed.	Check underneath the product and clear out as necessary (always wear protective gloves).
	Blade locknut loose.	Tighten locknut ensuring the blade, support flange and outer cap are all present and centered correctly (always wear protective gloves).
	Grass too high/dense.	<ul style="list-style-type: none"> <li>Grass too high: Cut in stages</li> <li>Grass too dense: Reduce rate of cutting every time.</li> </ul>
The grass becomes tangled around the motor shaft or the trimmer head.	Grass too high.	Cut in stages.
The cutting line is improperly cut.	The string cut-off blade becomes dull.	Sharpen the string cut-off blade with a file or replace it.
Too much vibration.	The line is worn down at one side and not advanced in time.	Make sure that the line on both sides is not damaged. Extend the line.
	The trimmer head is worn down.	Replace with a new trimmer head.
	The line has run out.	Install more line.
	Blade damaged.	Replace the blade (always wear protective gloves).
	Debris build up on cutting head.	Clean cutting head and remove debris.
	Blade locknut loose.	Tighten locknut ensuring the blade, support flange and outer cap are all present and centered correctly (always wear protective gloves).
	Blade incorrectly installed.	Remove the blade and refit in a central position.
Poor cutting performance	Cutting attachment guard encrusted with debris.	Clean inside of cutting attachment guard.
	Blade blunt.	Flip/replace the blade.

## 9 TECHNICAL DATA

Voltage	60 V
No load speed	6500 ± 10% RPM (String trimmer)
	6800 ± 10% RPM (Brush cutter)
Cutting line diameter	2.0 mm/2.4 mm
Cutting width	14 in. (35.6 cm) (String trimmer)
	16 in. (40.6 cm) (Brush cutter)
Line feeding system	Bump Feed

Battery model	G60B2/G60B3/G60B4/G60B4 and other BAC series
Charger model	G60UC and other CAC series



The recommended ambient temperature range:

Condition	Temperature
Product storage	32°F (0°C) - 113°F (45°C)
Product operation	32°F (0°C) - 113°F (45°C)
Battery charging	39°F (4°C) - 104°F (40°C)
Charger operation	39°F (4°C) - 104°F (40°C)
Battery storage	32°F (0°C) - 113°F (45°C)
Battery discharging	32°F (0°C) - 113°F (45°C)

## 10 WARRANTY

(The full warranty terms and conditions can be found on website )

The warranty is 4 years on the product and batteries, and 2 years on chargers (consumer/private usage) from the date of purchase. This warranty covers manufacturing faults. A faulty product under warranty might be either repaired or replaced. A unit that has been misused or used in other ways than described in the owner's manual might be rejected for warranty. Normal wear, and wear parts are not considered as warranty. The original manufacturer warranty is not affected by any additional warranty offered by a dealer or retailer.

A faulty product must be returned to the point of purchase in order to claim for warranty, together with the proof of purchase (receipt).

Our goods come with guarantees that cannot be excluded under the Australian Consumer Law. You are entitled to a replacement or refund for a major failure and compensation for any other reasonably foreseeable loss or damage. You are also entitled to have the goods repaired or replaced if the goods fail to be of acceptable quality and the failure does not amount to a major failure.



# greenworks<sup>®</sup>

[www.greenworksaustralia.com](http://www.greenworksaustralia.com)



P0806544-00